

# DIVINA XL 200x200

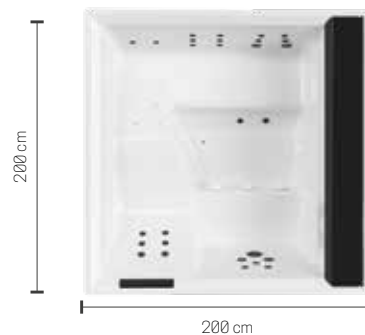

Dimensions cm 200 x 200 H 85

Seats

Capacity Lt. 930

Absorption Max Watt 3450

Max. weight kg 1610

FUNCTIONS	STANDARD	PLUS
Whirlpool jets	18	28
Whirlpool mini jets	4	6
Air regulation	2	2
UV purification system	●	●
White LED light	4	4
4 Chromolight	OPTIONAL	OPTIONAL
Headrest	-	●
Bluetooth audio system	OPTIONAL	OPTIONAL
Wi-Fi module	OPTIONAL	OPTIONAL
Single speed pump	-	●
Double speed pump	●	●
Heater 3 kW	●	●
Heat exchanger	OPTIONAL	OPTIONAL
Automatic refill	OPTIONAL	OPTIONAL
Fast emptying/filling + level control	OPTIONAL	OPTIONAL

## BATHTUB COLOUR



-W10 White -W20 Perla -W30 Marmo

## PANELS / SEAT AND HEADREST FIBER- CROSS

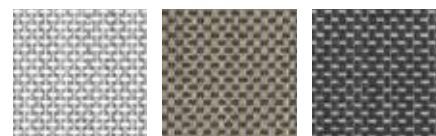

T1 Light grey T2 Warm brown T3 Steel

## CLAY PANELS

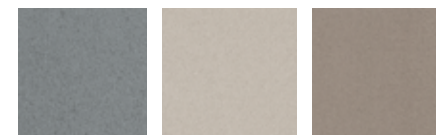

R Cenere O Polvere S Tortora

## NATURAL TOUCH PANELS

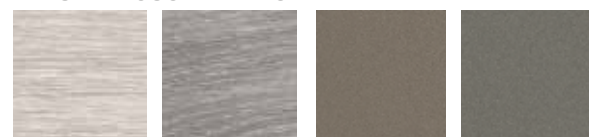

P1 Oak Alpine P2 Oak Concrete P3 Oxid P4 Quarz

## SLATTED PANELS



D1 Dark brown D2 Ice

## THERMAL COVER



C2 Brown C1 Plenty Grey

### DIVINA XL STANDARD

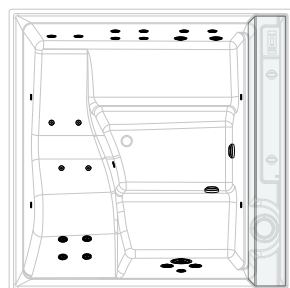

### DIVINA XL PLUS

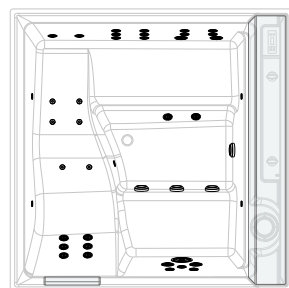

Code	Functions		Level control options			Bathtub Colour			Headrest/Side Seat Colour			
	UV + LED white	UV + Chromolight + audio BT	None	Automatic refill	Fast emptying/ filling + level control	White	Perla	Marmo	Black	Light Grey	Warm Brown	Steel

STANDARD												
	0X	6X	0	1	2	-W10	-W20	-W30	H	T1	T2	T3
DOXL50												
STANDARD WITH HEAT EXCHANGER												
	0R	6R	0	1	2	-W10	-W20	-W30	H	T1	T2	T3
DOXL50												
PLUS												
	0X	6X	0	1	2	-W10	-W20	-W30	H	T1	T2	T3
DOXL40												
PLUS WITH HEAT EXCHANGER												
	0R	6R	0	1	2	-W10	-W20	-W30	H	T1	T2	T3
DOXL40												

## PANELS

Code	Panels finishes			
NATURAL TOUCH				
	P1	P2	P3	P4
	Oak-Alpine	Oak-Concrete	Oxid	Quarz
PANV2F2LDIVDX-				
CLAY				
	R	O	S	
	Cenere	Polvere	Tortora	
PANV2F2LDIVDX-				
SLATTED PANELS				
	D1	D2		
	Dark Brown	Ice		
PADV2F2LDIVDX-				
FIBER-CROSS				
	T1	T2	T3	
	Light Grey	Warm Brown	Steel	
PATV2F2LDIVDX-				

## OPTIONAL

### WI-FI MODULE

Code	Price
DOMOWF	

### HEAT PUMP PREDISPOSITION KIT

Code	Price
DOKPDC	

### INSULATION KIT

Thermal insulation	Code	Price
Panels	KBT2F2LDOXL	
Bathtub bottom	DXTHCOFV	

### THERMAL COVER

Cover	Code	Price	
		C1	C2
Summer cover	DXTHCO-	Plenty Grey	Brown
Winter cover	DXTHCOT-		

Code composition: Code + Functions + Level control options + Bathtub Colour + Headrest/Side Seat Colour

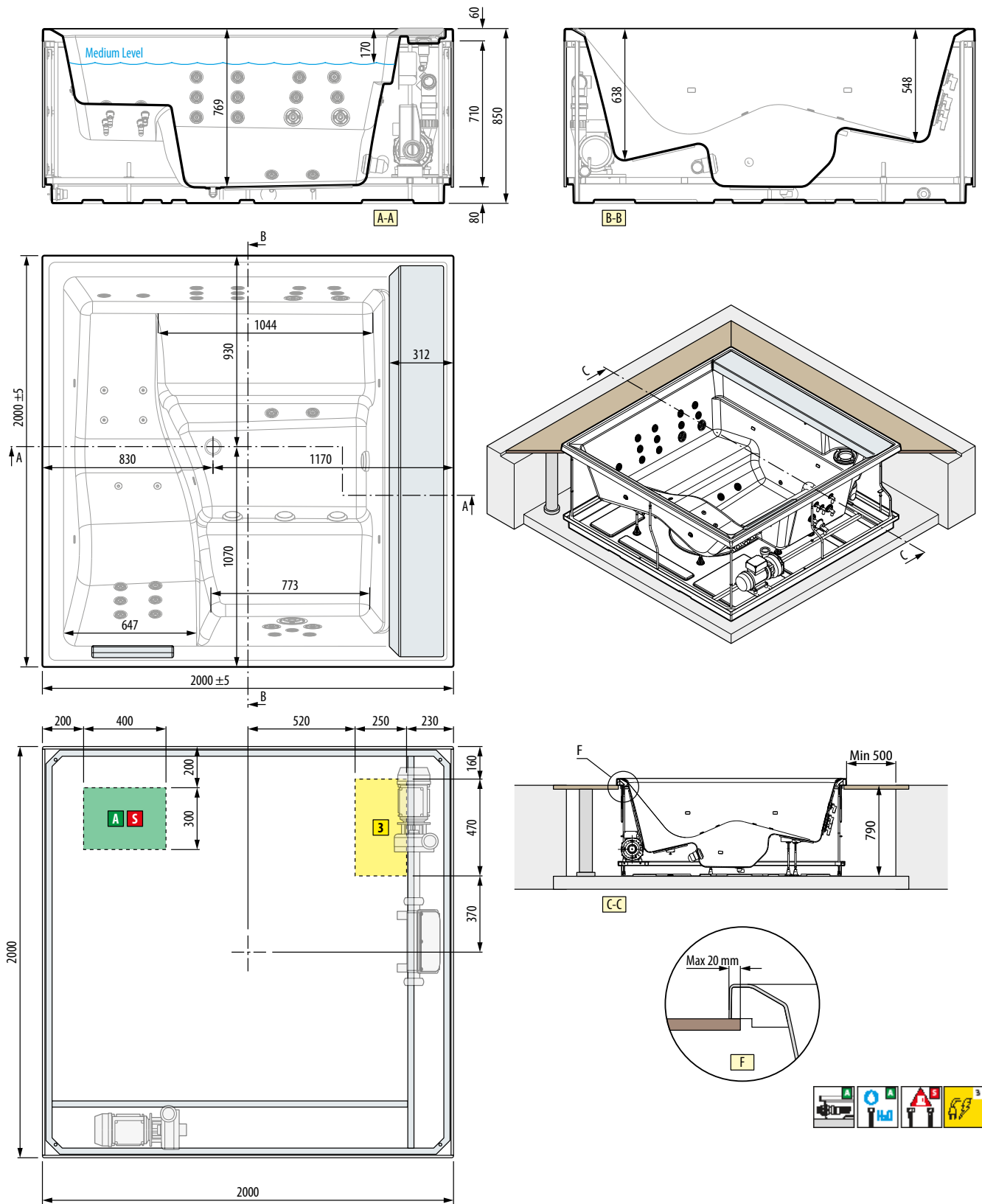

**HYDRAULIC SPECIFICATIONS**

Average capacity 930 litres  
 28 whirlpool (18 standard version)  
 8 mini jet (4 standard version)

**ELECTRICAL SPECIFICATIONS**

Power 230 V  
 Frequency 50 Hz  
 Max. power requirement 3450 W

**MECHANICAL CHARACTERISTICS**

Total area 4 m<sup>2</sup>  
 Total weight: 1610 kg  
 Bathtub+components mass 360 kg  
 Users mass (4 pers.) 80x4=320 kg  
 Specific load on support base 4030 N/m<sup>2</sup>